



LI-600 Porometer/Fluorometer Quick Start Guide

Online resources

-  **Computer Software** Configuration and data management, calibration, barcode generator: licor.com/600software
-  **Instruction Manual** Operating instructions, maintenance, and theory of operation: licor.com/600manual
-  **Technical Support** Manuals, software, videos, FAQs, tech tips, application notes, and more: licor.com/600support

What's what

- 1 Aperture:** Active measurement site, surrounds the leaf gasket.
- 2 Enter button:** Powers on, selects options, initiates or logs a measurement.
- 3 USB port:** Charges and connects to a computer with a micro-USB cable.
- 4 Fluorometer:** (Optional) Measures PAM chlorophyll *a* fluorescence.
- 5 Porometer:** Measures stomatal conductance.

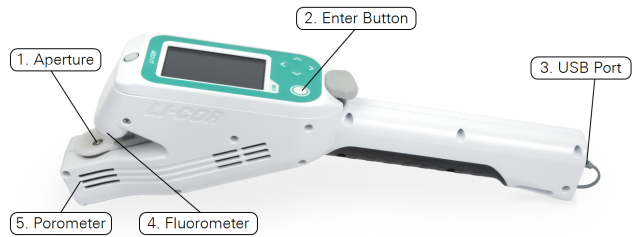

Charge the battery

The LI-600 arrives partially charged. Connect the LI-600 to a power source with the USB cable and charge to 100%.

Take a measurement in auto mode

The following instructions are for the preloaded **Auto** configuration on the instrument.

Step 1: Power on the LI-600.

Press and hold the **Enter button**.

Step 2: Select a configuration.

The **Select Configuration** screen will appear with two configurations. Select the Auto configuration and press the **Enter button**.

Step 3: Take a measurement and view the data.

The LI-600 will match and go to the Measurement screen. Clamp onto a leaf at the prompt. The LI-600 will search for stability, then log a measurement and beep when stability is reached. Release the leaf and view your data on the display. Press the **Enter button** to initiate a new measurement, or press the left arrow twice to navigate to **Settings** to shut down the instrument.

Step 4: Download the data.

To download data, install the LI-600 computer software. Connect the LI-600 to the computer via USB and download the data to the computer software. Export the data from the software as a .zip file that contains .csv and Excel files.

Working in auto mode

The workflow for taking a measurement will vary depending on settings in the configuration. The following is for auto mode with prompt on log disabled. See the user manual for detailed instructions on those settings.

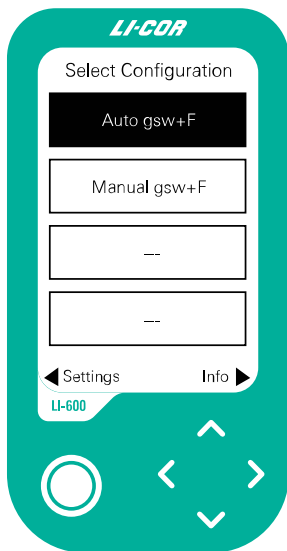

1

Select Configuration and Press the Enter button. The instrument will match.

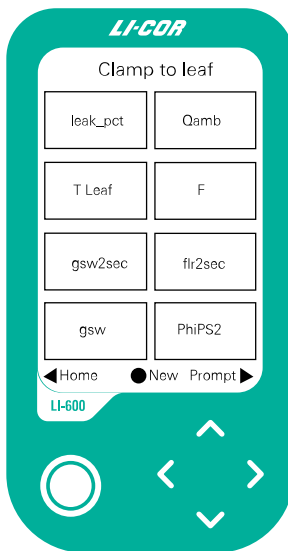

2

Clamp to a leaf. The LI-600 will automatically log a measurement. Unclamp the leaf and press the Enter button to initiate a new measurement.

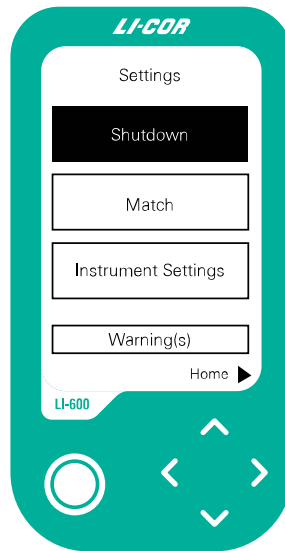

3

When finished, press the left arrow twice, select Shutdown and press the Enter button.

Measurement techniques

- **Fully fill the aperture with the leaf.** To get reliable stomatal conductance readings, the chamber must be covered and sealed.
- **Maintain the original orientation of the leaf.** Do not alter the angle or positioning of the leaf you are measuring.
- **Maintain the light conditions of the leaf.** Do not alter the light or shade the leaf you are measuring. If, while taking a measurement, you shade the leaf you plan to measure next, unshade the leaf and wait 60 seconds before measuring it.
- **Match the quantum sensor's light conditions to those of the leaf.** If the leaf you measure is in the light, ensure that the quantum sensor is also in the light. A mismatch between the leaf and the quantum sensor may result in a significant error in *ETR* calculation.
- **Avoid measuring a wet leaf.** If the leaf has water or condensation on it, gently and thoroughly dry the top and bottom of the leaf. Measuring a wet leaf may result in overestimation of stomatal conductance, and water ingress into the instrument may cause damage.
- **Avoid clamping onto the veins of the leaf.** The uneven surface may prevent the aperture clamp from properly sealing.

LI-COR Environmental

4647 Superior Street
Lincoln, Nebraska 68504
Phone: +1-402-467-3576
Toll free: 800-447-3576 (U.S. & Canada)
envsales@licor.com
envsupport@licor.com
licor.com/env

LI-COR GmbH, Germany

Siemensstraße 25A
61352 Bad Homburg
Germany
Phone: +49 (0) 6172 17 17 771
envsales-gmbh@licor.com
envsupport-eu@licor.com

LI-COR Ltd., United Kingdom

St. John's Innovation Centre
Cowley Road
Cambridge
CB4 0WS
United Kingdom
Phone: +44 (0) 1223 422102
envsales-UK@licor.com
envsupport-eu@licor.com

Beijing LI-COR Bioscience Ltd.

Room 502-503, 5th Floor, Jimen
No. 1 Office Building
Xitucheng Road, Haidian District
Beijing, China
Phone: +86-400-1131-511
china-sales@licor.com
china-support@licor.com

LI-COR Distributor Network

licor.com/env/distributors

LI-COR®

Copyright © 2023 LI-COR, Inc.
All rights reserved.
984-19038 • 12/2023